

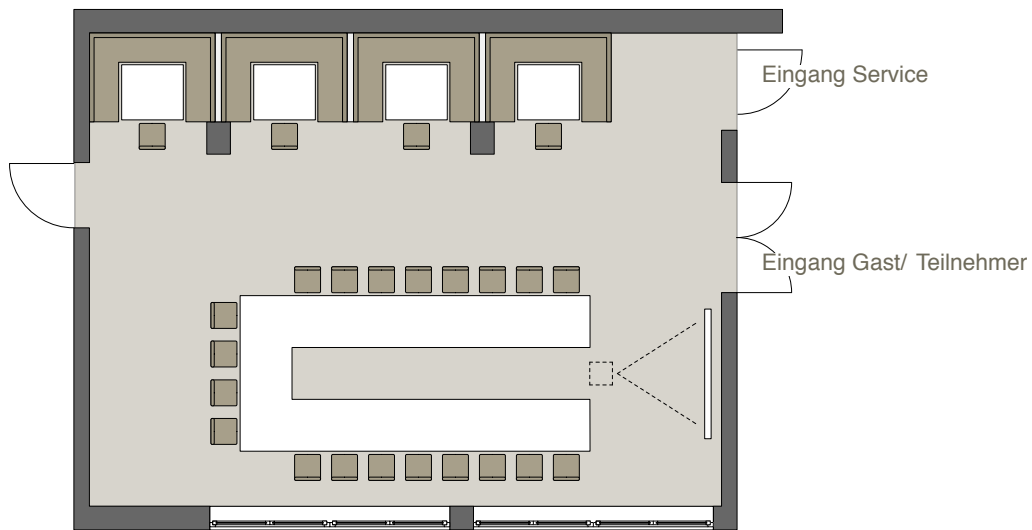

Auswahl möglicher Bestuhlungsvarianten Tassilo-Raum

Tassilo 1/ U-Form 20-35 Personen



Tassilo 2/ Parlamentarisch 20-30 Personen

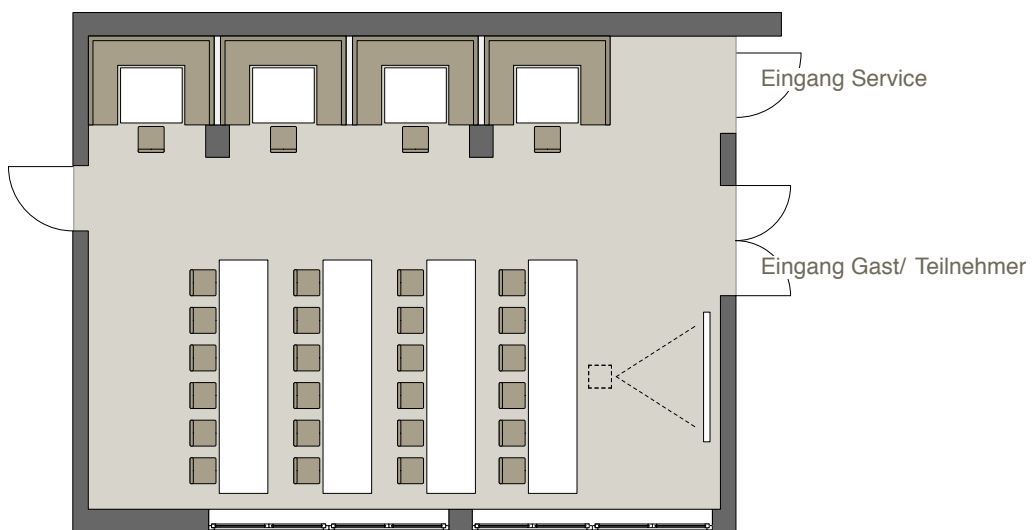



Tassilo Variante 3/ Stuhlkreis 15-20 Personen

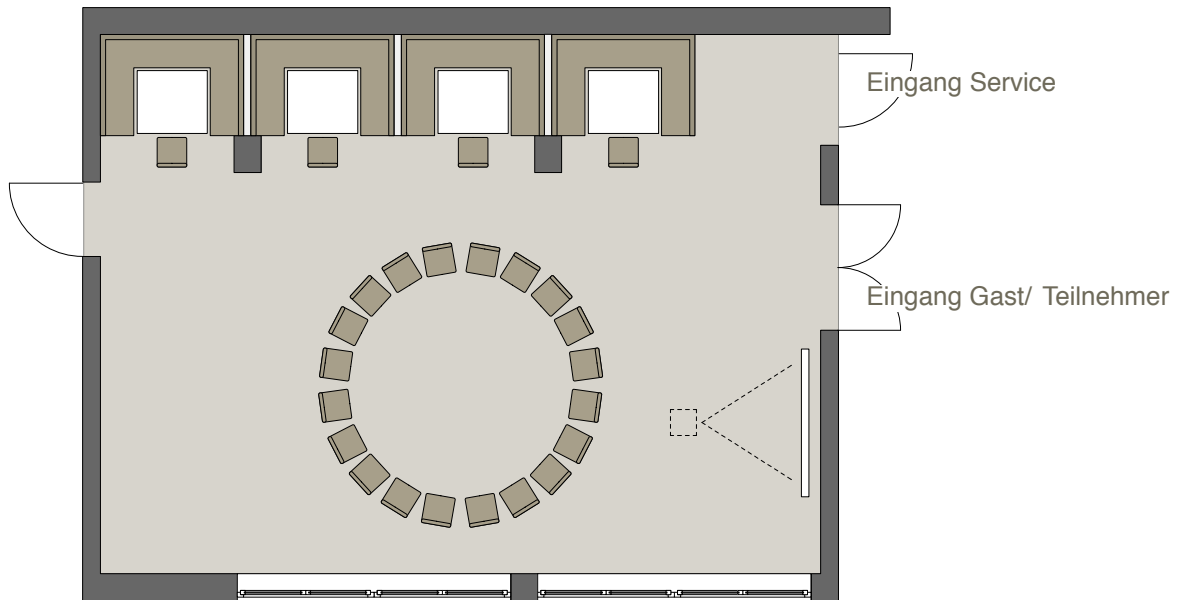

Tassilo 4/ Block 10-20 Personen

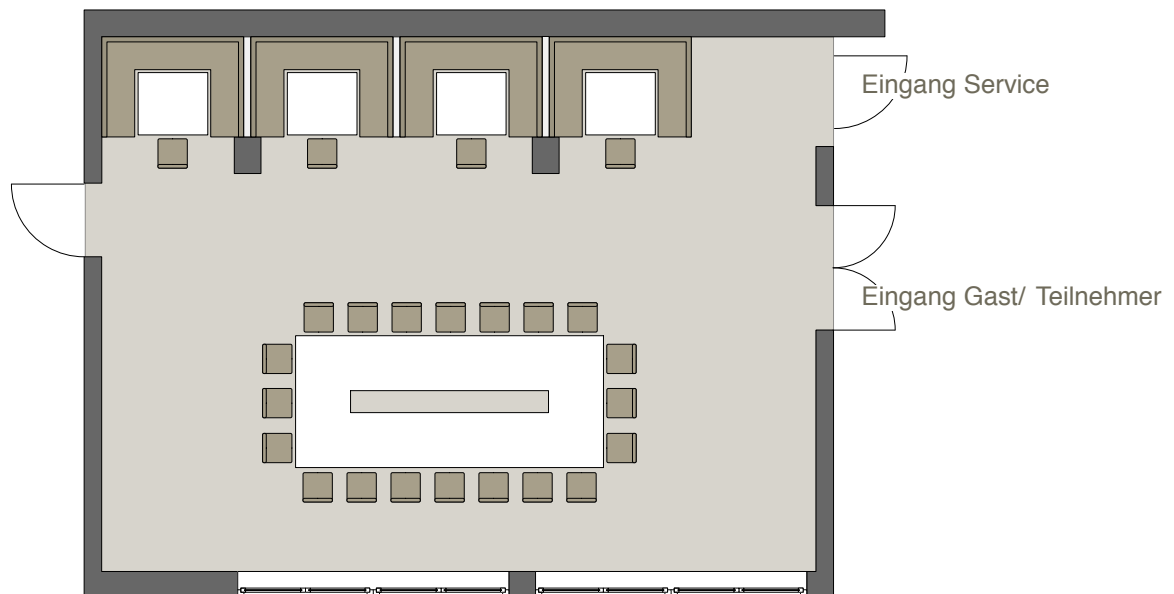



Tassilo 5/ Veranstaltung 25-40 Personen

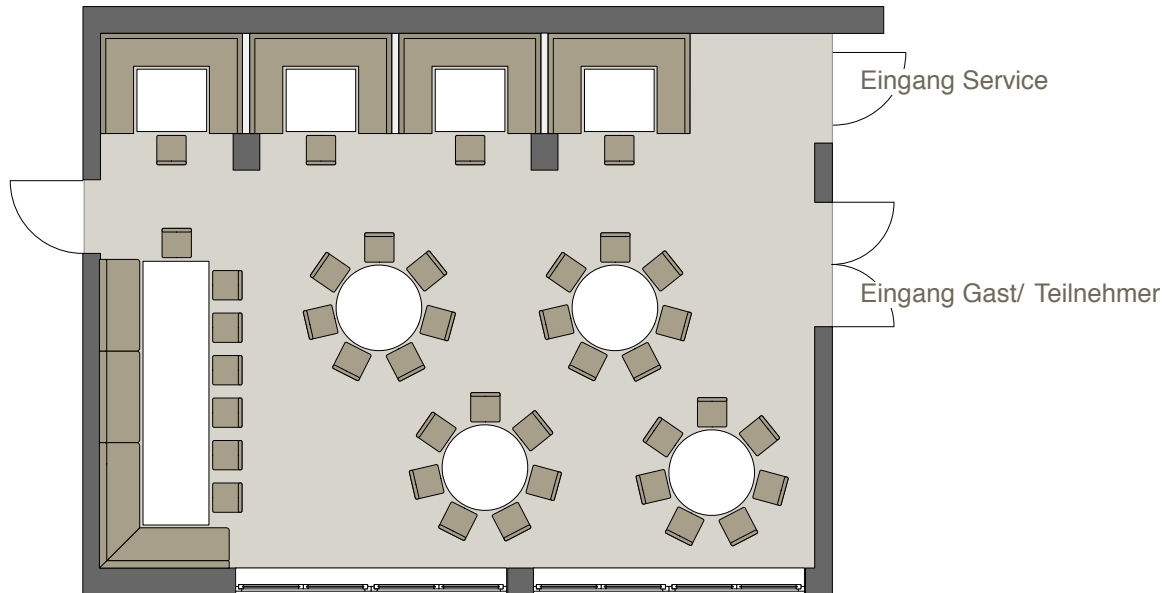

Tassilo 6/ Veranstaltung 20-30 Personen

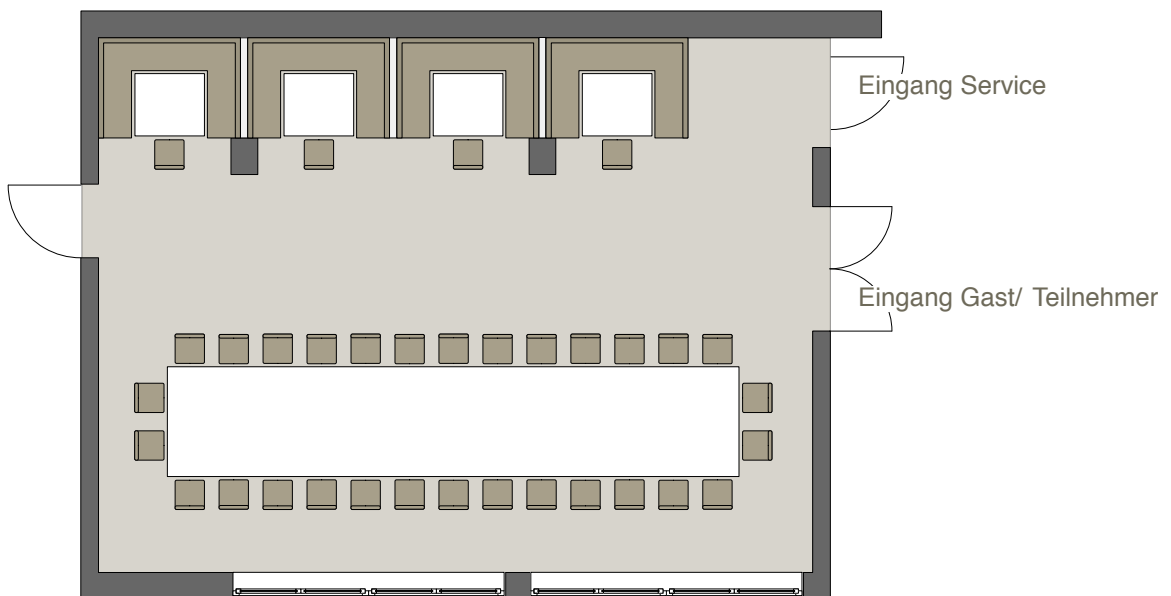



Tassilo 7/ Veranstaltung 36 Personen

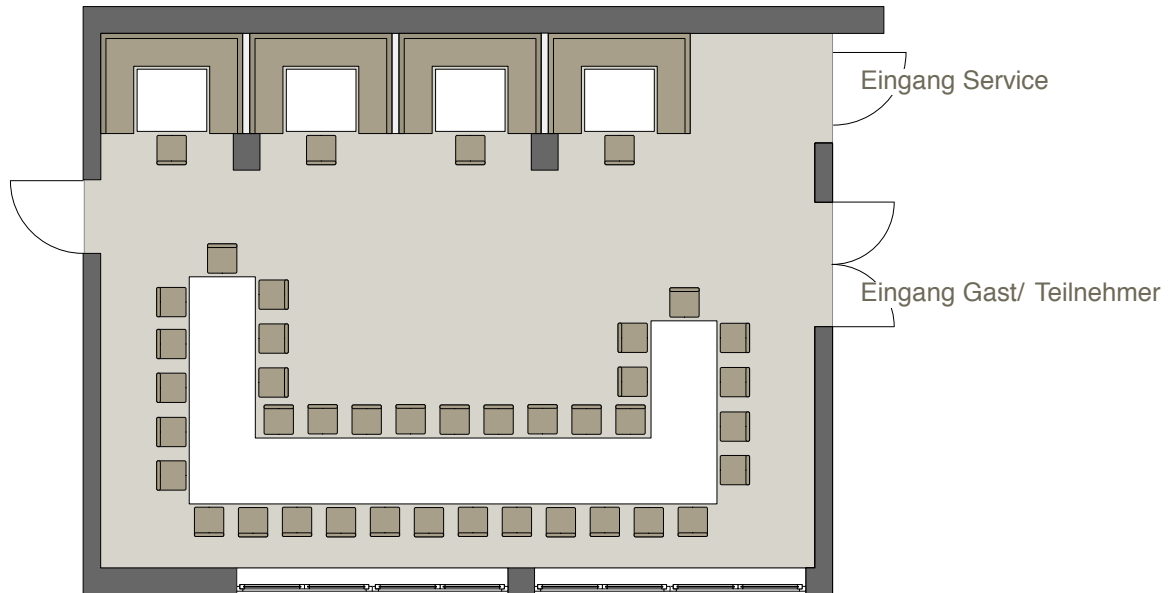

Tassilo 8/ Veranstaltung 45-65 Personen

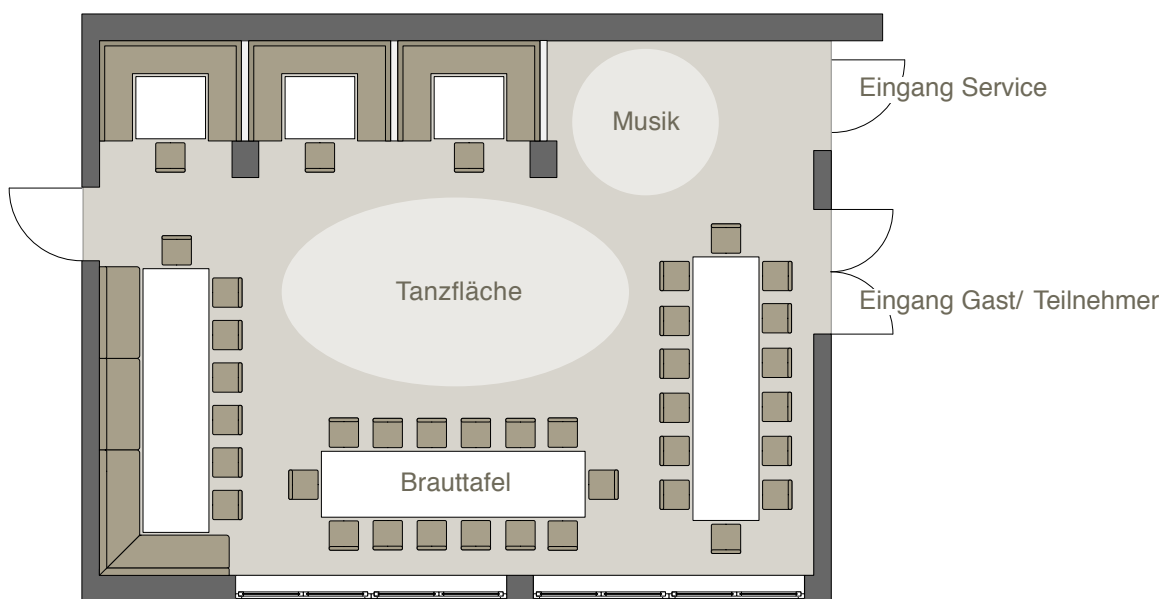



Tassilo 9/ Veranstaltung 55 Personen

